



Sale

Rawayana South

Rawai,

Rawai



฿ 4 819 500

₱ 11 842 861

\$ 140 347

€ 127 123

We present to you a unique project on the shore of the Andaman Sea - just 10 meters from the serene Rawai beach. This is not just real estate, it is an investment in your life in Phuket. With apartments ranging from 36 to 97 square meters and prices from 4,819,500 to 15,319,500 THB, the choice is yours - to become part of a community that not only lives in a comfortable, convenient, and safe place but also receives attractive rental income.

The project is planned to be completed in 2025, and you can already see how this complex is becoming the center of attraction in Rawai. The project includes 35 premium villas and 2 condominiums, each with a unique design concept and infrastructure.

By investing today, you can join the Rental Pool program, receiving 40% of the income, while the management company, covering all expenses, receives 60%. The projected yield is 5-10% per annum, and you start earning income immediately after the complex is handed over.

Additional advantages include:

Installment payment until the end of construction with an initial payment of 50%. The deposit is only 100,000 THB. Among 108 apartments, everyone will find something to their taste - all are equipped with designer furniture, decor, and appliances. The presence of a shopping center, supermarket, sports complex, and 3 swimming pools with panoramic sea views only emphasizes the exclusivity of this place. Children's areas, including a school and kindergarten, provide convenience for families, and proximity to the Big Buddha adds cultural value.

Additional expenses are also planned, including: 60 baht per sq. m. for monthly maintenance (paid annually), registration fees for property rights (Leasehold - 1.25%; Freehold - 2.25% + 350,000 baht), 500 baht per sq. m. for a capital repair fund (one-time payment), and an additional fee for the installation of meters - 5,000 baht. But there is a pleasant bonus - the furniture package is already included in the price.

Don't miss the chance to own a piece of paradise in Phuket. Book a viewing today. Kalinka Thailand brokers are always in touch!





The Project Name: **Rawayana South**
Housing Class: **Business class**
Completion Date: Year: **2025**



Construction Stage: **Under construction**
Ownership: **Freehold/leasehold available**
Completion Date: Quarter: **2**

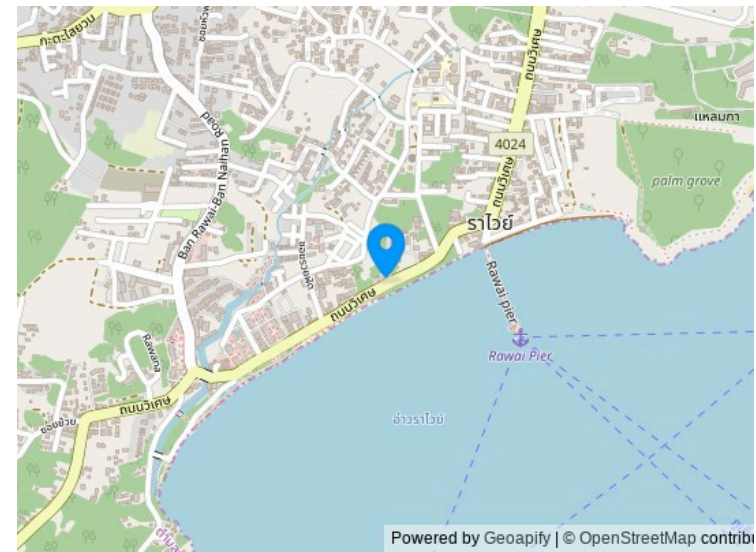
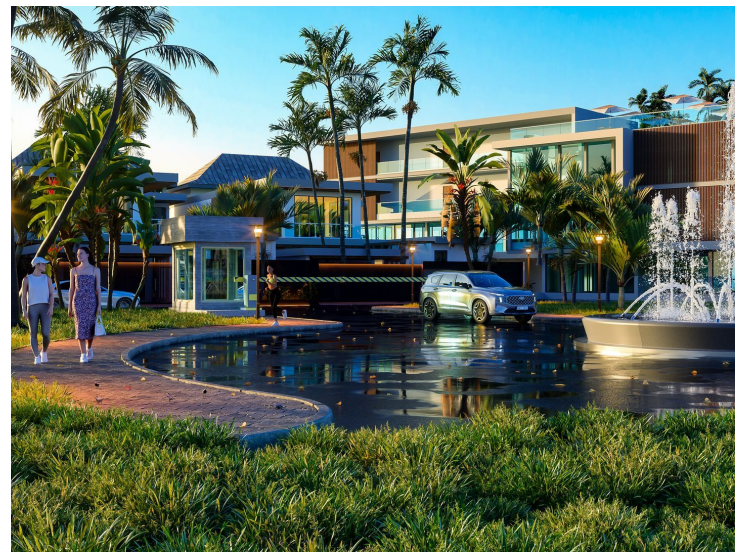
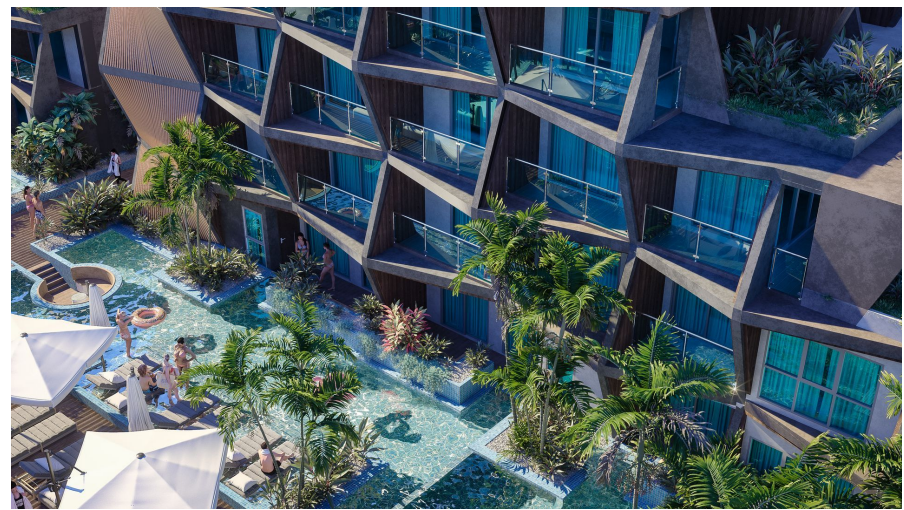

Layouts



Studio, 38 m²

from **฿ 4,819,500**

Bedrooms	Studio
Living Area	38 m ²
Floors	4
Bathrooms	1
Outdoor area	balcony
Furniture package	+
Floor	2

A studio in the Rawayana South condominium is a wonderful place not only for living or leisure but also an option for profitable investment.

Among the 108 apartments, everyone will find something to their taste - all of them are equipped with designer furniture, decor, and household appliances. The presence of a shopping center, supermarket, sports complex, and 3 swimming pools with a panoramic view of the sea only emphasizes the exclusivity of this place. Children's areas, including a school and a kindergarten, provide convenience for families, and the proximity to the Big Buddha adds cultural value.

Additional expenses are also planned, which include: 60 baht per sq. m. for monthly maintenance (paid annually), registration fees for property rights (Leasehold – 1.25%; Freehold – 2.25% + 350,000 baht), 500 baht per sq. m. for a capital repair fund (one-time payment), and an additional fee for the formalization and installation of meters - 5,000 baht. However, there is a pleasant bonus - the furniture package is already included in the price.

Layouts



2-bdr., 62 m²

from ฿ 7,969,500

Bedrooms	2
Living Area	62 m ²
Floors	4
Bathrooms	2
Outdoor area	balcony
Furniture package	+
Floor	2

Two-bedroom apartments in the Rawayana South condominium are a wonderful place not only for living or leisure but also an option for profitable investment.

Among the 108 apartments, everyone will find something to their taste - all of them are equipped with designer furniture, decor, and household appliances. The presence of a shopping center, supermarket, sports complex, and 3 swimming pools with a panoramic view of the sea only emphasizes the exclusivity of this place. Children's areas, including a school and a kindergarten, provide convenience for families, and the proximity to the Big Buddha adds cultural value.

Additional expenses are also planned, which include: 60 baht per sq. m. for monthly maintenance (paid annually), registration fees for property rights (Leasehold - 1.25%; Freehold - 2.25% + 350,000 baht), 500 baht per sq. m. for a capital repair fund (one-time payment), and an additional fee for the formalization and installation of meters - 5,000 baht. However, there is a pleasant bonus - the furniture package is already included in the price.

Layouts



1-bdr., 72 m²

from ฿ 10,384,500

Bedrooms	1
Living Area	72 m ²
Floors	4
Bathrooms	1
Outdoor area	balcony
Furniture package	+
Floor	2

One-bedroom apartments in the Rawayana South condominium are a wonderful place not only for living or leisure but also an option for profitable investment.

Among the 108 apartments, everyone will find something to their taste - all of them are equipped with designer furniture, decor, and household appliances. The presence of a shopping center, supermarket, sports complex, and 3 swimming pools with a panoramic view of the sea only emphasizes the exclusivity of this place. Children's areas, including a school and kindergarten, provide convenience for families, and the proximity to the Big Buddha adds cultural value.

Additional expenses are also planned, which include: 60 baht per sq. m. for monthly maintenance (paid annually), registration fees for property rights (Leasehold - 1.25%; Freehold - 2.25% + 350,000 baht), 500 baht per sq. m. for a capital repair fund (one-time payment), and an additional fee for the formalization and installation of meters - 5,000 baht. However, there is a pleasant bonus - the furniture package is already included in the price.

Layouts



2-bdr., 71 m²

from ฿ 11,224,500

Bedrooms	2
Living Area	71 m ²
Floors	4
Bathrooms	2
Outdoor area	balcony
Furniture package	+
Floor	2

2-bedroom apartments in the Rawayana South condominium are a wonderful place not only for living or leisure but also an option for profitable investment.

Among the 108 apartments, everyone will find something to their taste - all of them are equipped with designer furniture, decor, and household appliances. The presence of a shopping center, supermarket, sports complex, and 3 swimming pools with a panoramic view of the sea only emphasizes the exclusivity of this place. Children's areas, including a school and kindergarten, provide convenience for families, and the proximity to the Big Buddha adds cultural value.

Additional expenses are also planned, which include: 60 baht per sq. m. for monthly maintenance (paid annually), registration fees for property rights (Leasehold - 1.25%; Freehold - 2.25% + 350,000 baht), 500 baht per sq. m. for a capital repair fund (one-time payment), and an additional fee for the formalization and installation of meters - 5,000 baht. However, there is a pleasant bonus - the furniture package is already included in the price.



Marketing Director

Yury Golovanov

y.golovanov@kalinka-realty.com

Kalinka Thailand

+66 97 783 0676
kalinka-thailand.com
office@kalinka-thailand.com

